

Dana Dolly Setup Sheet

NOTE: DO NOT PLACE THE DANA DOLLY SHUTTLE ON GROUND.

BE VERY CAREFUL OF THE ENDS: MAKE SURE THE DOLLY AND CAMERA DON'T FALL.

Make sure your location is dry and flat. It is best to setup with 2 people.



Place Speed Rail Track End Bracket with the junior pin facing up on the ground and insert rails. Lock down both rails with the 4 locks. Do this with the other end of the speed rail.

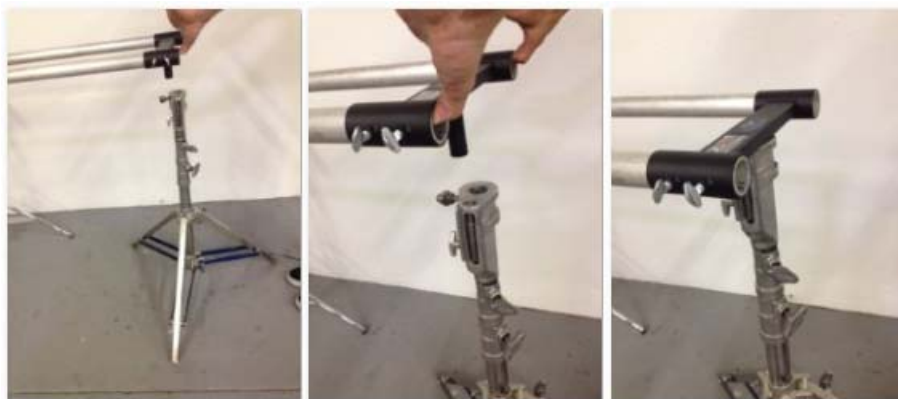

Adjust the Low Boy Combo Stands to the desired height you want to have the rails at. With two people lift up rails and flip over so junior pins are facing down. Place both ends in the junior receiver holes (in the top of the low boy combo stands).

Lock the pins into the stands.



Place the Center Support Bar onto the Silver Kit Stand. Raise the support in the center of the rails to give support, but do not raise the rails above where they rest. Lock stand and support. You can use multiple supports with additional kit stands (not included) for longer speed rail.

NOTE: DO NOT PLACE THE DANA DOLLY SHUTTLE ON GROUND.

NOTE: BE VERY CAREFUL OF THE ENDS: MAKE SURE THE DOLLY AND CAMERA DON'T FALL.

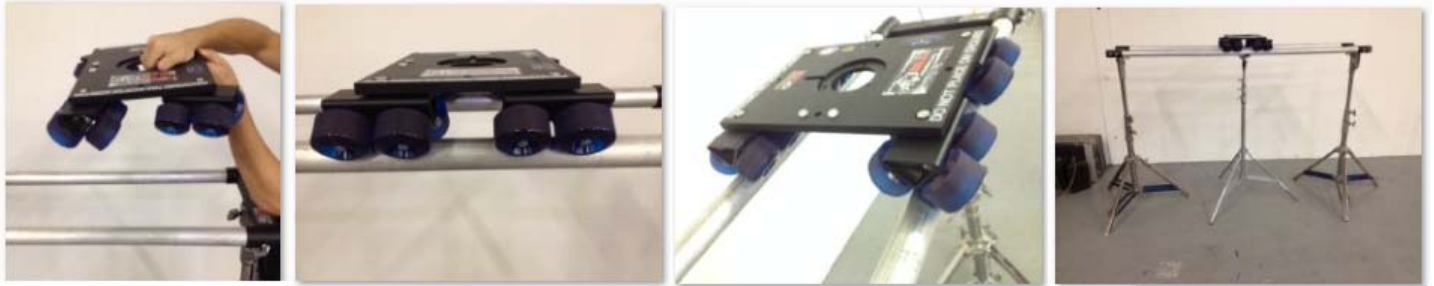

Place the Dana Dolly Shuttle on the speed rail. The labels on the shuttle should be on the outsides. Make sure all wheels are aligned correctly on the rails and dolly runs smoothly.

You can place the level on the shuttle to make sure it is level. If it is not level adjust stands.



There are 2 size bowl adapters:

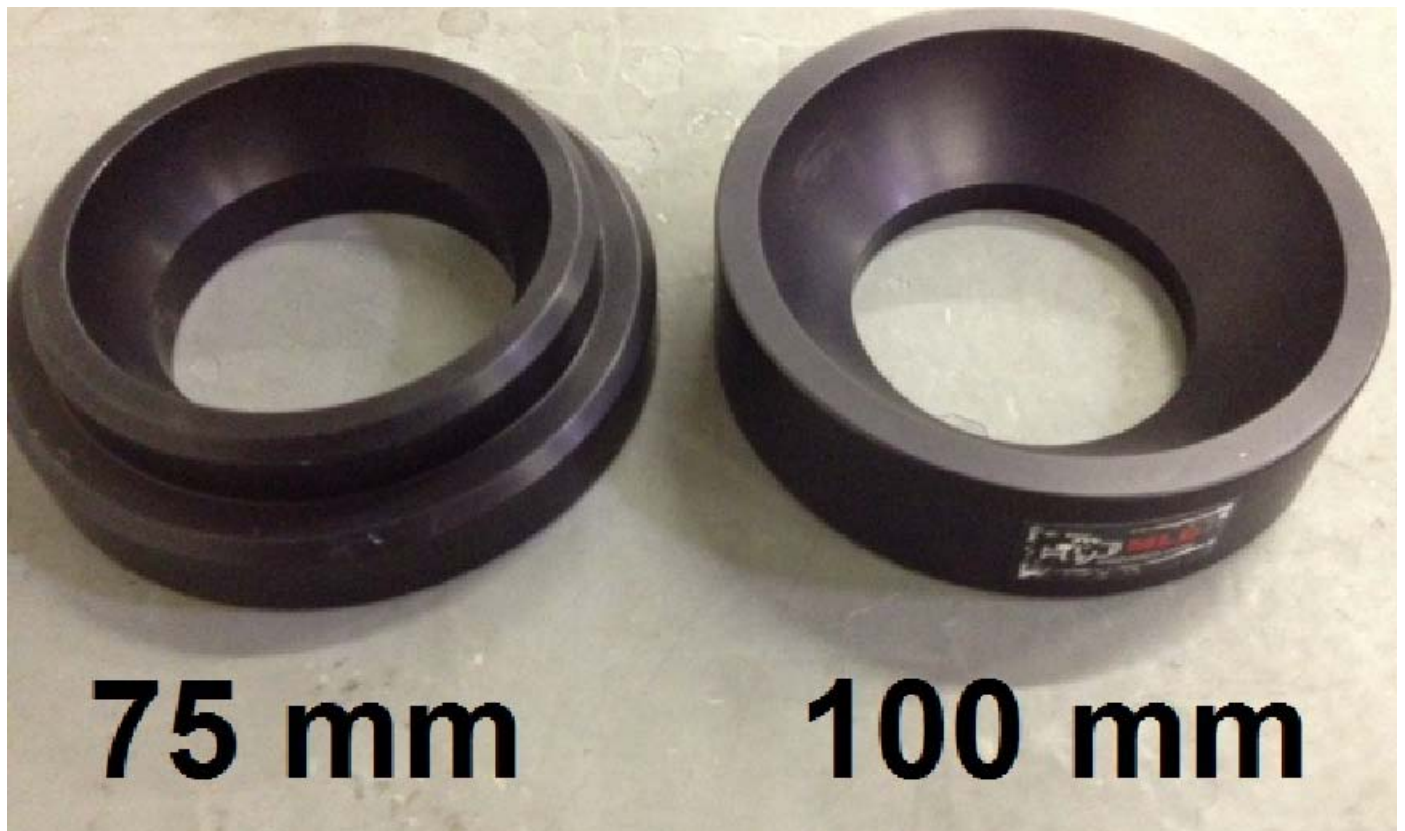

Manfrotto 502HD Dana Dolly Setup Sheet

(Not Included)

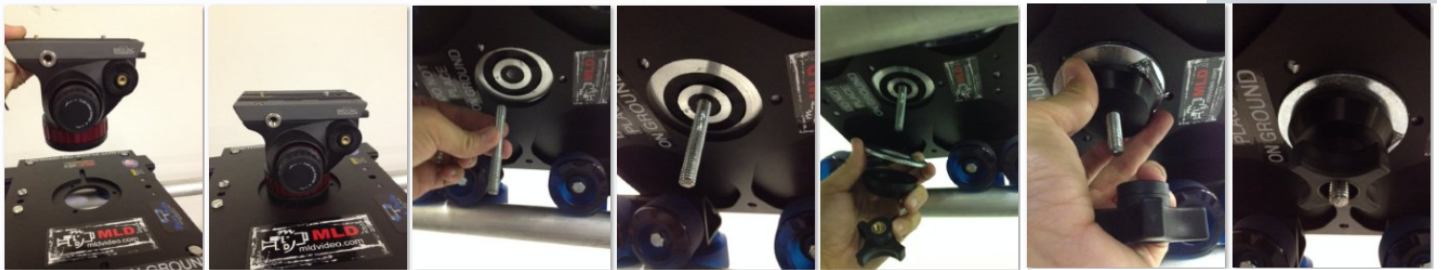

For our Manfrotto 502HD Flat-Base Tripod Head you would place the head on the top of the Dolly Shuttle. Screw the 3" all thread into the bottom of the head. Place the 3" Silver Washer, the 3" Cup with hole, and lock it all down with the 4 Spoke Lock.

After assembling, leveling, and locking down the tripod head be sure the shuttle does not hit any support and runs smoothly along the track.

NOTE: DO NOT LOCK DOWN WITH THE LONG HANDLE LOCK FROM YOUR TRIPOD. THIS WILL HIT THE CENTER SUPPORT AND DAMAGE THE DOLLY.

NOTE: DO NOT PLACE THE DANA DOLLY SHUTTLE ON GROUND.

NOTE: BE VERY CAREFUL OF THE ENDS: MAKE SURE THE DOLLY AND CAMERA DON'T FALL.

SACHTLER 75mm Dana Dolly Setup Sheet

(Not Included)



For a Sachtler 75mm bowl tripod. Place the 75mm bowl adapter on top of the shuttle. Place the tripod head into the bowl. Put the 3" Silver washer and 3" black cup with hole under the shuttle on the tripod threading, and lock down with the 6 Spoke Black Lock.

After assembling, leveling, and locking down the tripod head be sure the shuttle does not hit any support and runs smoothly along the track.

NOTE: DO NOT LOCK DOWN WITH THE LONG HANDLE LOCK FROM YOUR TRIPOD. THIS WILL HIT THE CENTER SUPPORT AND DAMAGE THE DOLLY.

NOTE: DO NOT PLACE THE DANA DOLLY SHUTTLE ON GROUND.

NOTE: BE VERY CAREFUL OF THE ENDS: MAKE SURE THE DOLLY AND CAMERA DON'T FALL.

SACHTLER 100mm Dana Dolly Setup Sheet

(Not Included)



For a Sachtler 100mm tripod. Place the 100mm bowl adapter on top of the shuttle. Place the tripod head into the bowl. Put the 3" Silver washer and 3" black cup with hole under the shuttle on the tripod threading, and lock down with the 4 Spoke Lock and Cup (attached) from the original Tripod Lock Down.

After assembling, leveling, and locking down the tripod head be sure the shuttle does not hit any support and runs smoothly along the track.

NOTE: DO NOT LOCK DOWN WITH THE LONG HANDLE LOCK FROM YOUR TRIPOD. THIS WILL HIT THE CENTER SUPPORT AND DAMAGE THE DOLLY.

NOTE: DO NOT PLACE THE DANA DOLLY SHUTTLE ON GROUND.

NOTE: BE VERY CAREFUL OF THE ENDS: MAKE SURE THE DOLLY AND CAMERA DON'T FALL.

Dana Dolly Floor Setup Sheet (Not Included)

NOTE: DO NOT PLACE THE DANA DOLLY SHUTTLE ON GROUND.

NOTE: BE VERY CAREFUL OF THE ENDS: MAKE SURE THE DOLLY AND CAMERA DON'T FALL.

Make sure your location is dry and flat. It is best to setup with 2 people.

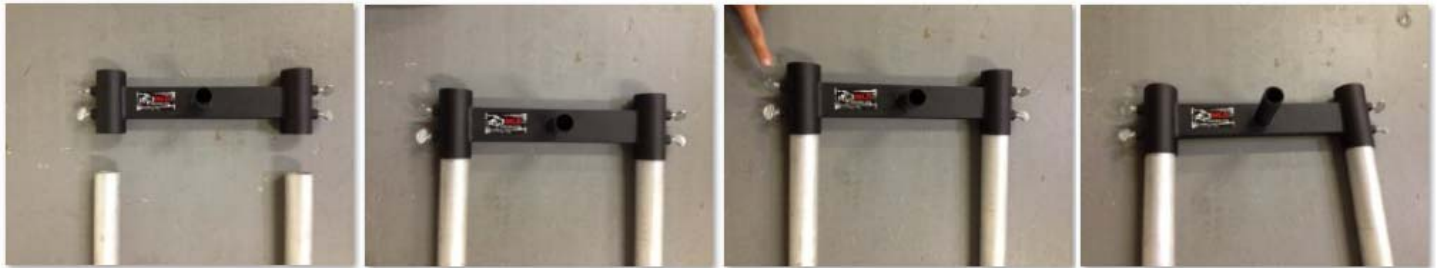

Place Speed Rail Track End Bracket with the junior pin facing up on the ground and insert rails. Lock down both rails with the 4 locks. Do this with the other end of the speed rail.

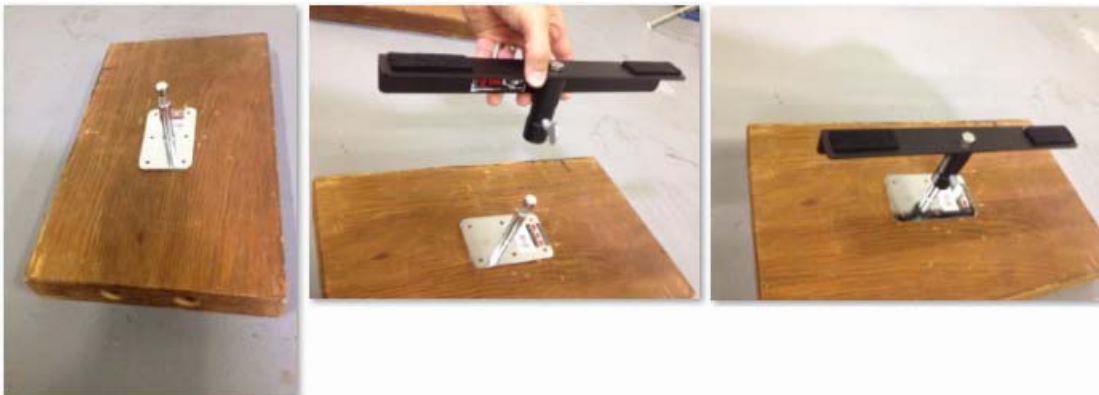

The baby plate will be attached to the apple box. Place the Center Support Bar on the baby plate. Lock down.

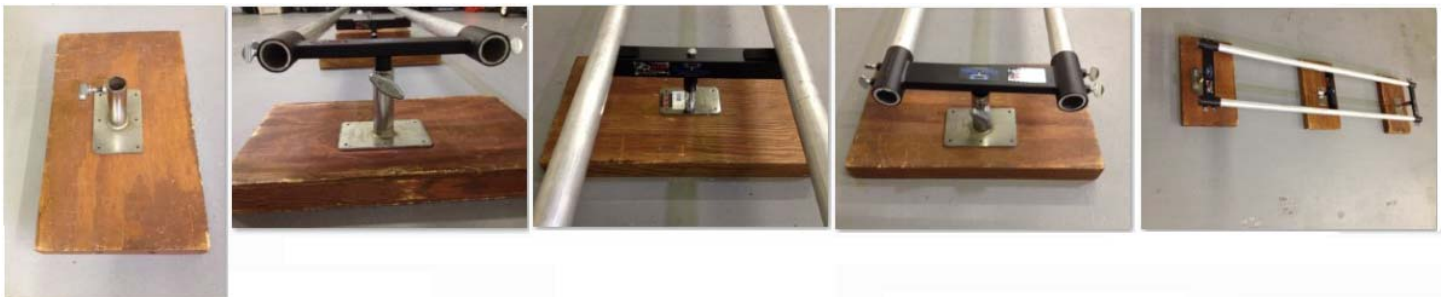

The Junior receiver plates will be attached to the apple boxes. Place the Baby plate attached to apple box in the middle of the two junior plates attached to apple boxes.

With two people lift up rails and flip over so junior pins are facing down. Place both ends in the junior receiver plates attached to the apple boxes.

Level rails and lock down both ends.